

64



STRUCTURAL DESIGN
FULLY OPEN (CARPORT) BUILDING

MAXIMUM 30'-0" WIDE X 20'-0" EAVE HEIGHT-
BOX EAVE FRAME AND BOW FRAME

11 December 2020
Revision 9
M&A Project No.
16062S/16155S/16207S/17155S/17200S/18068S/18156S/18290S/20019S/20324S

Prepared for:

Steel Buildings and Structures, Inc.
P.O. Box 1287
Mt. Airy, NC 27030

Prepared by:

Moore and Associates Engineering
and Consulting, Inc.

1009 East Avenue
North Augusta, SC 29841





401 S. Main St., Suite 200
Mt. Airy, NC 27030

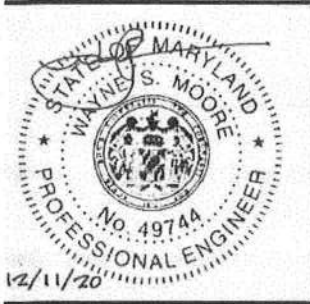
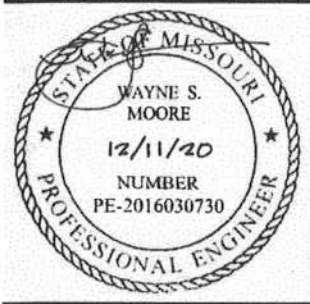

| | | | |
|--|--|--|--|
| | | | |
| | | I HAVE RESEARCHED THIS CHAPTER AND THE LOUISIANA STATE UNIFORM CONSTRUCTION CODE AND TO THE BEST OF MY KNOWLEDGE AND BELIEF, THESE DRAWINGS ARE IN COMPLIANCE THEREWITH. I TAKE FULL RESPONSIBILITY FOR THE CONTENTS OF THESE PLANS. | |
| | | | |
| | | | |
| | | | |

| | | | | | |
|--|--|-----------------|---------------|--|--|
| MOORE AND ASSOCIATES ENGINEERING AND CONSULTING, INC. | | DRAWN BY: LT | | STEEL BUILDINGS AND STRUCTURES, INC. P.O. BOX 1287, MOUNT AIRY, NC 27030 30'-0" x 20'-0" FULLY OPEN STRUCTURE | |
| | | CHECKED BY: PDH | | | |
| PROJECT MGR: VSM | | DATE: 12-11-20 | SCALE: NTS | JOB NO: 18068S/18156S 18290S/20019S/20324S | |
| CLIENT: SBSI | | SHT. 1 | DWG. NO: SK-1 | REV: 9 | |

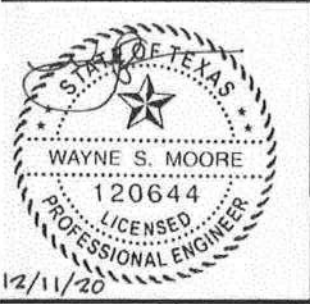
THIS DOCUMENT IS THE PROPERTY OF MOORE AND ASSOCIATES ENGINEERING AND CONSULTING. THE UNAUTHORIZED REPRODUCTION, COPYING, OR OTHERWISE USE OF THIS DOCUMENT IS STRICTLY PROHIBITED AND ANY INFRINGEMENT THEREUPON MAY BE SUBJECT TO LEGAL ACTION.

| | | | |
|--|---|--|--|
|  | <p>Professional Certification. I hereby certify that these documents were prepared or approved by me, and that I am a duly licensed professional engineer under the laws of the State of Maryland, License No. 49744, Expiration Date 12/11/20</p> | | |
|  |  | | |
|  | | | |
|  | | | |
|  | | | |

| | | | | |
|---|------------------------|--|-----------------------|--|
| <p>MOORE AND ASSOCIATES ENGINEERING AND CONSULTING, INC.</p> | <p>DRAWN BY: LT</p> | <p>STEEL BUILDINGS AND STRUCTURES, INC. P.O. BOX 1287, MOUNT AIRY, NC 27030 30'-0" x 20'-0" FULLY OPEN STRUCTURE</p> | | |
| | <p>CHECKED BY: PDH</p> | <p>PROJECT MGR: WSM</p> | <p>DATE: 12-11-20</p> | <p>SCALE: NTS</p> |
| <p><small>THIS DOCUMENT IS THE PROPERTY OF MOORE AND ASSOCIATES ENGINEERING AND CONSULTING. THE UNAUTHORIZED REPRODUCTION, COPYING, OR OTHERWISE USE OF THIS DOCUMENT IS STRICTLY PROHIBITED AND ANY INFRINGEMENT THEREUPON MAY BE SUBJECT TO LEGAL ACTION.</small></p> | <p>CLIENT: SBSI</p> | <p>SHT. 1A</p> | <p>DWG. NO: SK-1</p> | <p>JOB NO: 18068S/18156S 18290S/20019S/20324S REV: 9</p> |

DRAWING INDEX

| | |
|----------|---|
| SHEET 1 | PE SEAL COVER SHEET (1 OF 2) |
| SHEET 1A | PE SEAL COVER SHEET (2 OF 2) |
| SHEET 2 | DRAWING INDEX |
| SHEET 3 | INSTALLATION NOTES AND SPECIFICATIONS |
| SHEET 4 | TYPICAL SIDE AND END ELEVATIONS |
| SHEET 5 | TYPICAL RAFTER/COLUMN END AND SIDE FRAMING SECTION (BOX EAVE STRUCTURE) |
| SHEET 5A | TYPICAL RAFTER/COLUMN END AND SIDE FRAMING SECTION (BOX EAVE STRUCTURE) |
| SHEET 5B | TYPICAL RAFTER/COLUMN END AND SIDE FRAMING SECTION (BOX EAVE STRUCTURE) |
| SHEET 6 | COLUMN CONNECTION DETAILS (BOX EAVE STRUCTURE) |
| SHEET 6A | COLUMN CONNECTION DETAILS (BOX EAVE STRUCTURE) |
| SHEET 7 | TYPICAL RAFTER/COLUMN END AND SIDE FRAMING SECTION (BOW EAVE STRUCTURE) |
| SHEET 7A | TYPICAL RAFTER/COLUMN END AND SIDE FRAMING SECTION (BOW EAVE STRUCTURE) |
| SHEET 7B | TYPICAL RAFTER/COLUMN END AND SIDE FRAMING SECTION (BOW EAVE STRUCTURE) |
| SHEET 8 | COLUMN CONNECTION DETAILS (BOW EAVE STRUCTURE) |
| SHEET 8A | COLUMN CONNECTION DETAILS (BOW EAVE STRUCTURE) |
| SHEET 9 | BASE RAIL ANCHORAGE OPTIONS |
| SHEET 9A | ADDITIONAL BASE RAIL ANCHORAGE OPTION |
| SHEET 10 | CONNECTION DETAILS |
| SHEET 11 | GABLE END OPTION (BOX EAVE STRUCTURE) |
| SHEET 12 | GABLE END OPTION (BOW EAVE STRUCTURE) |
| SHEET 13 | EXTRA SIDE PANEL OPTION (BOX EAVE STRUCTURE) |
| SHEET 14 | EXTRA SIDE PANEL OPTION (BOW EAVE STRUCTURE) |
| SHEET 15 | VERTICAL ROOF OPTION END AND SIDE ELEVATION AND SECTION |
| SHEET 16 | OPTIONAL BASE RAIL ON GRADE APPLICATION |
| SHEET 17 | OPTIONAL BASE RAIL ON TIMBER BEAM |
| SHEET 18 | OPTIONAL BASE RAIL ON TIMBER BEAM WITH SOIL NAIL |
| SHEET 19 | OPTIONAL CONCRETE STRIP FOOTING |

**MOORE AND ASSOCIATES
ENGINEERING AND CONSULTING, INC.**

DRAWN BY: LT
CHECKED BY: PDH

STEEL BUILDINGS AND STRUCTURES, INC.
P.O. BOX 1287,
MOUNT AIRY, NC 27030
30'-0" x 20'-0" FULLY OPEN STRUCTURE

HIS DOCUMENT IS THE PROPERTY OF MOORE AND ASSOCIATES ENGINEERING AND CONSULTING. THE UNAUTHORIZED REPRODUCTION, COPYING, OR OTHERWISE USE OF HIS DOCUMENT IS STRICTLY PROHIBITED AND ANY INFRINGEMENT THEREUPON MAY BE SUBJECT TO LEGAL ACTION.

PROJECT MGR: WSM
CLIENT: SBSI

DATE: 12-11-20
SHT. 2

SCALE: NTS
DVG. NO: SK-1

JOB NO: 18068S/18156S
18290S/20019S/20324S
REV: 9

INSTALLATION NOTES AND SPECIFICATIONS

1. DESIGN IS FOR MAXIMUM 30'-0" WIDE x 20'-0" EAVE HEIGHT OPEN CARPORT STRUCTURES
2. DESIGN WAS DONE IN ACCORDANCE WITH THE 2020 FLORIDA BUILDING CODE (FBC) 7TH EDITION, 2018 NORTH CAROLINA BUILDING CODE, 2006 INTERNATIONAL BUILDING CODE (IBC), 2009 IBC, 2012 IBC, 2015 IBC AND 2018 IBC
3. DESIGN LOADS ARE AS FOLLOWS:
 - A) DEAD LOAD = 15 PSF
 - B) LIVE LOAD = 12 PSF
 - C) GROUND SNOW LOAD = 30 PSF (< 26'-0"), 35 PSF (26'-0" < W < 30'-0")

NOTE: UNBALANCED SNOW LOADS DUE TO DRIFTING HAVE NOT BEEN EVALUATED
4. 3-SECOND GUST ULTIMATE WIND SPEED (V_{ULT}) = 105 TO 145 MPH (NOMINAL WIND SPEED = 82 TO 112 MPH)
5. MAXIMUM RAFTER/COLUMN AND END COLUMN SPACING = 50 FEET (UNLESS NOTED OTHERWISE)
6. END WALL COLUMNS (POSTS) ARE EQUIVALENT TO SIDE WALL POSTS IN SIZE AND SPACING (UNLESS NOTED OTHERWISE).
7. RISK CATEGORY I.
8. WIND EXPOSURE CATEGORY B
9. SPECIFICATIONS APPLICABLE TO 29 GAUGE METAL PANELS FASTENED DIRECTLY TO 2 1/2" x 2 1/2" - 14 GAUGE TUBE STEEL (TS) FRAMING MEMBERS (UNLESS NOTED OTHERWISE).
10. AVERAGE FASTENER SPACING ON-CENTERS ALONG RAFTERS OR HAT CHANNELS, AND COLUMNS (INTERIOR OR END) = 8 INCHES.
11. FASTENERS CONSIST OF 1/4"x3/4" SELF-DRILLING FASTENER (SDF), USE CONTROL SEAL WASHER WITH EXTERIOR FASTENERS. SPECIFICATIONS APPLICABLE ONLY FOR MEAN ROOF HEIGHT OF 20 FEET OR LESS, AND ROOF SLOPES OF 14" (3:12 PITCH) OR LESS SPACING REQUIREMENTS FOR OTHER ROOF HEIGHTS AND/OR SLOPES MAY VARY. ROOF SLOPES LESS THAN 3:12 REQUIRE USE OF LAP JOINT SEALANT
12. GROUND ANCHORS SHALL BE INSTALLED THROUGH BASE RAIL WITHIN 6" OF EACH COLUMN
13. STANDARD GROUND ANCHORS (SOIL NAILS) CONSIST OF #4 REBAR W/ WELDED NUT x 36" LONG AND MAY BE USED IN SUITABLE SOILS. OPTIONAL ANCHORAGE MAY BE USED IN SUITABLE SOILS AND MUST BE USED IN UNSUITABLE SOILS AS NOTED
14. WIND FORCES GOVERN OVER SEISMIC FORCES. SEISMIC PARAMETERS ANALYZED ARE:
 - SOIL SITE CLASS = D
 - RISK CATEGORY I
 - R = 3.25 $I_f = 1.0$
 - $S_{BS} = 2.039 g$ $V = C_s W$
 - $S_{DI} = 1.258 g$

| | | | | |
|---|------------------------|--|-----------------------|--|
| MOORE AND ASSOCIATES ENGINEERING AND CONSULTING, INC. | DRAWN BY: LT | STEEL BUILDINGS AND STRUCTURES, INC. P.O. BOX 1287, MOUNT AIRY, NC 27030 30'-0"x20'-0" FULLY OPEN STRUCTURE | | |
| | CHECKED BY: PDH | PROJECT MGR: WSM | DATE: 12-11-20 | SCALE: NTS |
| THIS DOCUMENT IS THE PROPERTY OF MOORE AND ASSOCIATES ENGINEERING AND CONSULTING. THE UNAUTHORIZED REPRODUCTION, COPYING, OR OTHERWISE USE OF THIS DOCUMENT IS STRICTLY PROHIBITED AND ANY INFRINGEMENT THEREUPON MAY BE SUBJECT TO LEGAL ACTION. | CLIENT: SBSI | SHT. 3 | DWG. NO: SK-1 | JOB NO: 18068S/18156S 18290S/20019S/20324S REV.: 9 |

BOX EAVE FRAME RAFTER STRUCTURE

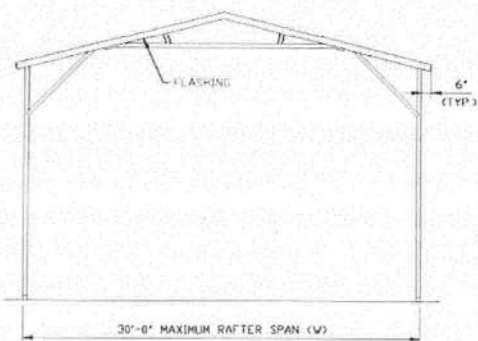

TYPICAL END ELEVATION
SCALE: NTS

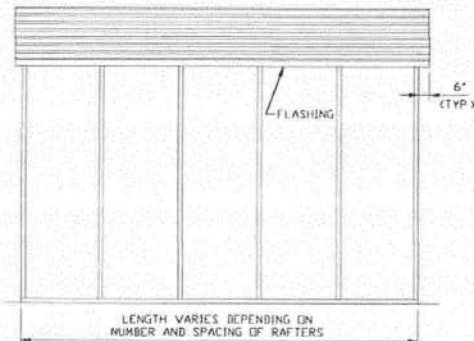

TYPICAL SIDE ELEVATION
SCALE: NTS

BOW EAVE FRAME RAFTER STRUCTURE

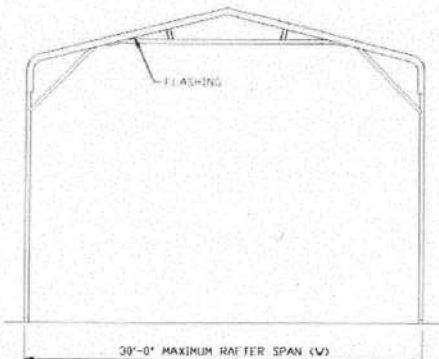

TYPICAL END ELEVATION
SCALE: NTS

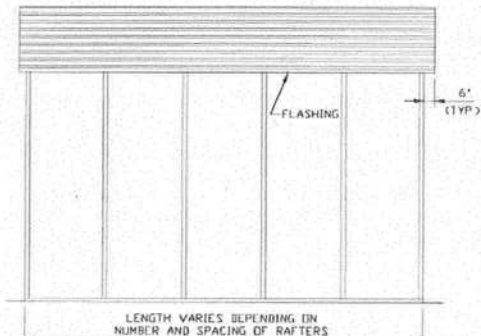

TYPICAL SIDE ELEVATION
SCALE: NTS

**MOORE AND ASSOCIATES
ENGINEERING AND CONSULTING, INC.**

DRAWN BY: LT

CHECKED BY: PDH

PROJECT MGR: VSM

CLIENT: SBSI

STEEL BUILDINGS AND STRUCTURES, INC.
P.O. BOX 1287,
MOUNT AIRY, NC 27030

30'-0" x 20'-0" FULLY OPEN STRUCTURE

DATE: 12-11-20

SHT. 4

SCALE: NTS

DWG. NO: SK-1

JOB NO: 18069S/18156S
18290S/20019S/20324S

REV: 9

THIS DOCUMENT IS THE PROPERTY OF MOORE AND ASSOCIATES ENGINEERING AND CONSULTING. THE UNAUTHORIZED REPRODUCTION, COPYING, OR OTHERWISE USE OF THIS DOCUMENT IS STRICTLY PROHIBITED AND ANY INFRINGEMENT THEREUPON MAY BE SUBJECT TO LEGAL ACTION.

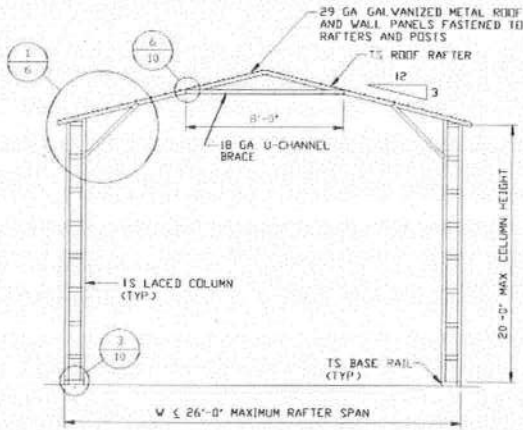

TYPICAL RAFTER/COLUMN FRAME SECTION
SCALE: NTS

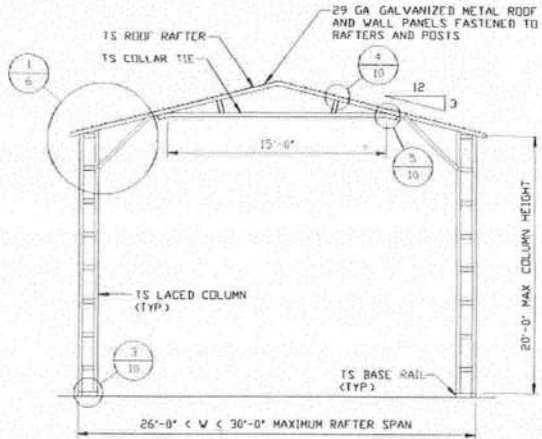

TYPICAL RAFTER/COLUMN END FRAME SECTION
SCALE: NTS

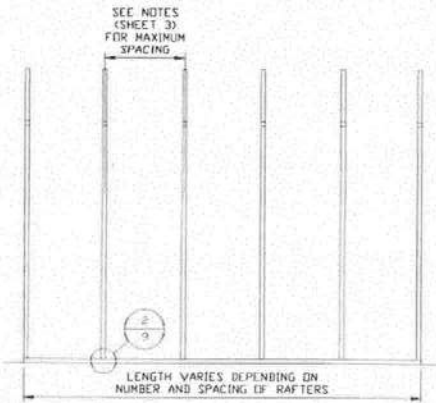

TYPICAL RAFTER/COLUMN SIDE FRAMING SECTION
SCALE: NTS

**MOORE AND ASSOCIATES
ENGINEERING AND CONSULTING, INC.**

DRAWN BY: LT

CHECKED BY: PDH

PROJECT MGR: VSM

CLIENT: SBSI

STEEL BUILDINGS AND STRUCTURES, INC.
P.O. BOX 1287,
MOUNT AIRY, NC 27030
30'-0" x 20'-0" FULLY OPEN STRUCTURE

DATE: 12-11-20

SCALE: NTS

DWG. NO: SK-1

JOB NO: 18068S/18156S

18290S/20019S/20324S

SHT. 5

REV: 9

HIS DOCUMENT IS THE PROPERTY OF MOORE AND ASSOCIATES ENGINEERING AND CONSULTING. THE UNAUTHORIZED REPRODUCTION, COPYING, OR OTHERWISE USE OF HIS DOCUMENT IS STRICTLY PROHIBITED AND ANY INFRINGEMENT THEREUPON MAY BE SUBJECT TO LEGAL ACTION.

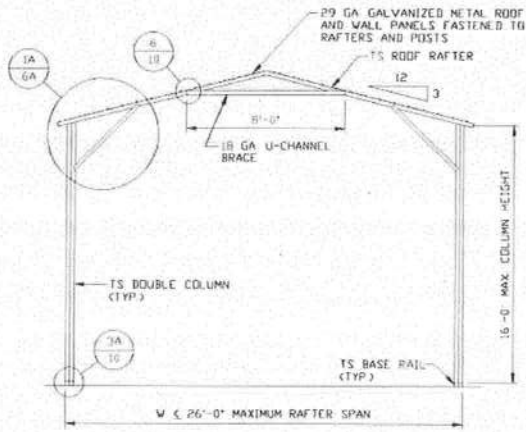

TYPICAL RAFTER/COLUMN FRAME SECTION
SCALE: NTS

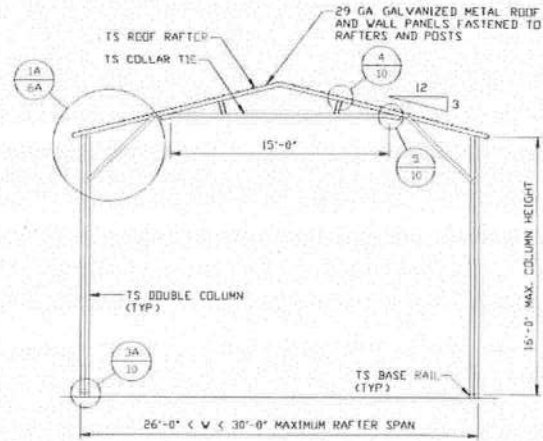

TYPICAL RAFTER/COLUMN END FRAME SECTION
SCALE: NTS

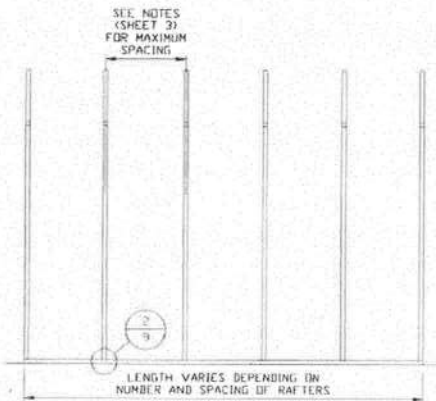

TYPICAL RAFTER/COLUMN SIDE FRAMING SECTION
SCALE: NTS

**MOORE AND ASSOCIATES
ENGINEERING AND CONSULTING, INC.**

DRAWN BY: LT
CHECKED BY: PDH
PROJECT MGR: WSM
CLIENT: SBSI

STEEL BUILDINGS AND STRUCTURES, INC.
P.O. BOX 1287,
MOUNT AIRY, NC 27030
30'-0" x 20'-0" FULLY OPEN STRUCTURE

DATE: 12-11-20
SCALE: NTS
SHT. 5A
DWG. NO: SK-1
REV. 9

HIS DOCUMENT IS THE PROPERTY OF MOORE AND ASSOCIATES ENGINEERING AND CONSULTING. THE UNAUTHORIZED REPRODUCTION, COPYING, OR OTHERWISE USE OF HIS DOCUMENT IS STRICTLY PROHIBITED AND ANY INFRINGEMENT THEREUPON MAY BE SUBJECT TO LEGAL ACTION.

JOB NO: 18068S/18156S
18290S/20019S/20324S

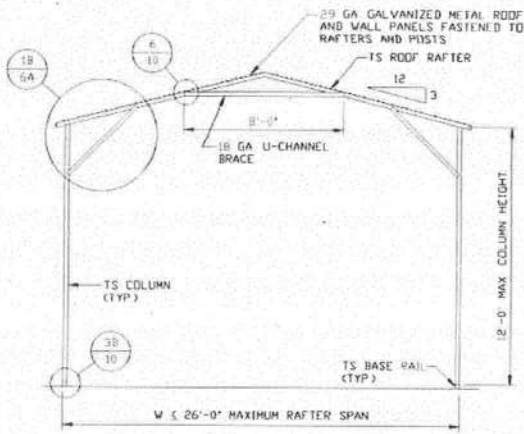

TYPICAL RAFTER/COLUMN FRAME SECTION
SCALE: NTS

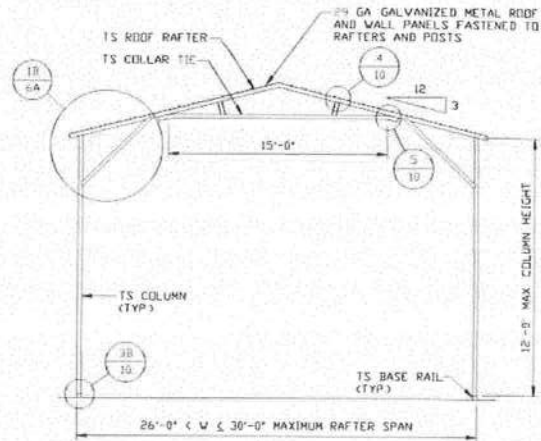

TYPICAL RAFTER/COLUMN END FRAME SECTION
SCALE: NTS

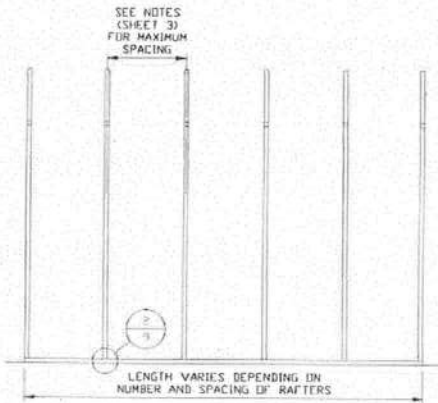

TYPICAL RAFTER/COLUMN SIDE FRAMING SECTION
SCALE: NTS

**MOORE AND ASSOCIATES
ENGINEERING AND CONSULTING, INC.**

DRAWN BY: LT

CHECKED BY: PDH

PROJECT MGR: VSM

CLIENT: SBSI

STEEL BUILDINGS AND STRUCTURES, INC.
P.O. BOX 1287,
MOUNT AIRY, NC 27030
30'-0"x20'-0" FULLY OPEN STRUCTURE

DATE: 12-11-20

SHT. 5B

SCALE: NTS

DWG. NO: SK-1

JOB NO: 18068S/18156S
18290S/20019S/20324S

REV: 9

HIS DOCUMENT IS THE PROPERTY OF MOORE AND ASSOCIATES ENGINEERING AND CONSULTING. THE UNAUTHORIZED REPRODUCTION, COPYING, OR OTHERWISE USE OF HIS DOCUMENT IS STRICTLY PROHIBITED AND ANY INFRINGEMENT THEREUPON MAY BE SUBJECT TO LEGAL ACTION.

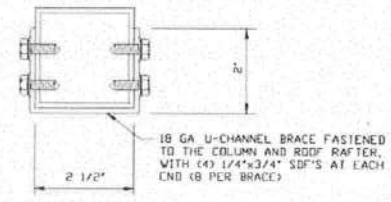
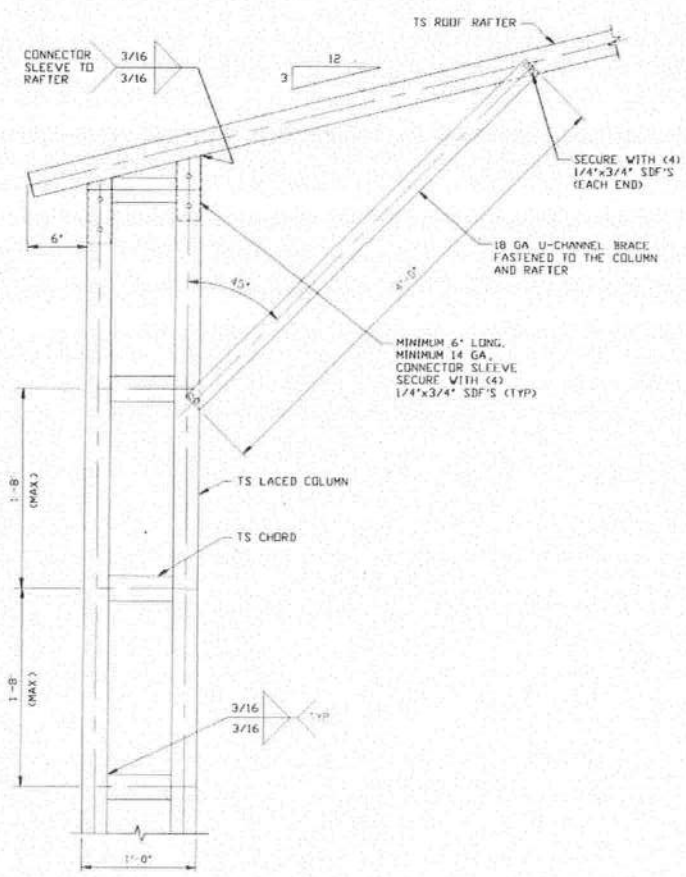

BRACE SECTION
SCALE: NTS

BOX EAVE RAFTER/CORNER POST CONNECTION DETAIL
FOR HEIGHTS 16'-0" < TO ≤ 20'-0"
SCALE: NTS

1

MOORE AND ASSOCIATES
ENGINEERING AND CONSULTING, INC.

DRAWN BY: LT
CHECKED BY: PDH

STEEL BUILDINGS AND STRUCTURES, INC.
P.O. BOX 1287,
MOUNT AIRY, NC 27030
30'-0" x 20'-0" FULLY OPEN STRUCTURE

HIS DOCUMENT IS THE PROPERTY OF MOORE AND ASSOCIATES ENGINEERING AND CONSULTING. THE UNAUTHORIZED REPRODUCTION, COPYING, OR OTHERWISE USE OF HIS DOCUMENT IS STRICTLY PROHIBITED AND ANY INFRINGEMENT THEREUPON MAY BE SUBJECT TO LEGAL ACTION.

PROJECT MGR: WSM
CLIENT: SBSI

DATE: 12-11-20
SHT. 6

SCALE: NTS
DWG. NO: SK-1

JOB NO: 18068S/18156S
18290S/20019S/20324S
REV: 9

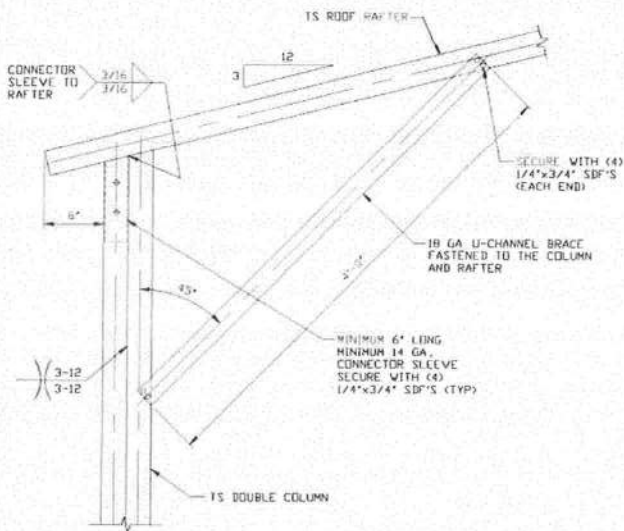

BOX EAVE RAFTER/CORNER POST CONNECTION DETAIL FOR HEIGHTS 12'-0" < TO <= 16'-0"

1A

SCALE: NTS

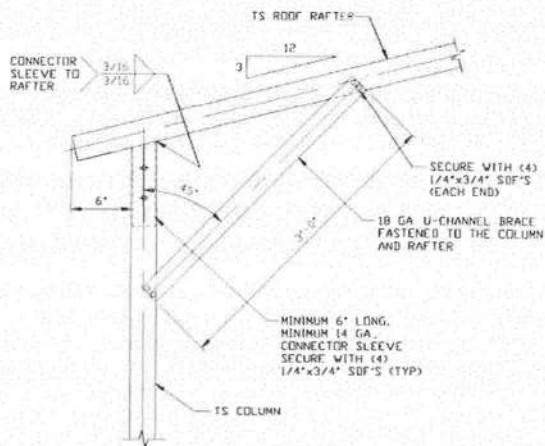

BOX EAVE RAFTER/CORNER POST CONNECTION DETAIL FOR HEIGHTS <= 12'-0"

1B

SCALE: NTS

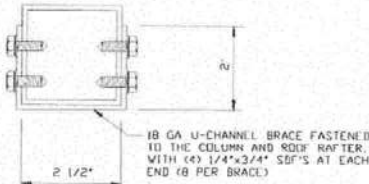

BRACE SECTION

SCALE: NTS

**MOORE AND ASSOCIATES
ENGINEERING AND CONSULTING, INC.**

DRAWN BY: LT

CHECKED BY: PDH

PROJECT MGR: WSM

CLIENT: SBSI

STEEL BUILDINGS AND STRUCTURES, INC.
P.O. BOX 1287,
MOUNT AIRY, NC 27030
30'-0"X20'-0" FULLY OPEN STRUCTURE

DATE: 12-11-20

SCALE: NTS

JOB NO: 18068S/18156S
18290S/20019S/20324S

SHT. 6A

DWG. NO: SK-1

REV. 9

THIS DOCUMENT IS THE PROPERTY OF MOORE AND ASSOCIATES ENGINEERING AND CONSULTING. THE UNAUTHORIZED REPRODUCTION, COPYING, OR OTHERWISE USE OF THIS DOCUMENT IS STRICTLY PROHIBITED AND ANY INFRINGEMENT THEREUPON MAY BE SUBJECT TO LEGAL ACTION.

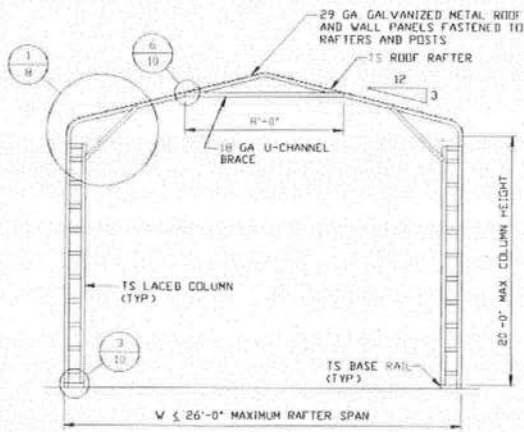

TYPICAL RAFTER/COLUMN FRAME SECTION
SCALE: NTS

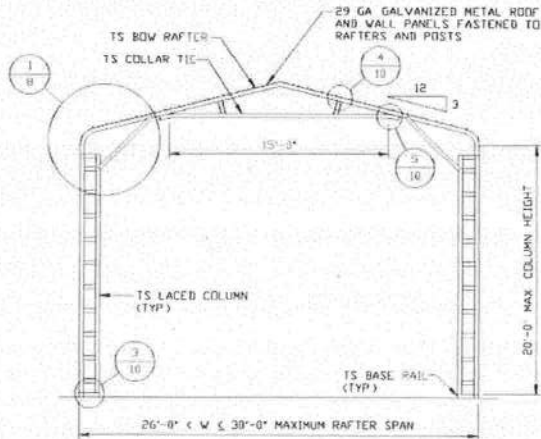

TYPICAL RAFTER/COLUMN END FRAME SECTION
SCALE: NTS

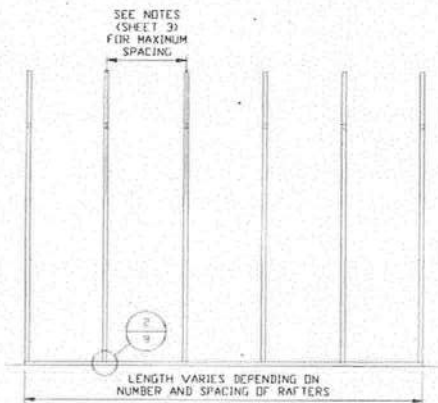

TYPICAL RAFTER/COLUMN SIDE FRAMING SECTION
SCALE: NTS

**MOORE AND ASSOCIATES
ENGINEERING AND CONSULTING, INC.**

DRAWN BY: LT

CHECKED BY: PDH

PROJECT MGR: VSM

CLIENT: SBSI

STEEL BUILDINGS AND STRUCTURES, INC.
P.O. BOX 1287,
MOUNT AIRY, NC 27030
30'-0"x20'-0" FULLY OPEN STRUCTURE

DATE: 12-11-20

SHT. 7

SCALE: NTS

DWG. NO: SK-1

JOB NO: 18068S/18156S
18290S/20019S/20324S

REV. 9

HIS DOCUMENT IS THE PROPERTY OF MOORE AND ASSOCIATES ENGINEERING AND CONSULTING. THE UNAUTHORIZED REPRODUCTION, COPYING, OR OTHERWISE USE OF HIS DOCUMENT IS STRICTLY PROHIBITED AND ANY INFRINGEMENT THEREUPON MAY BE SUBJECT TO LEGAL ACTION.

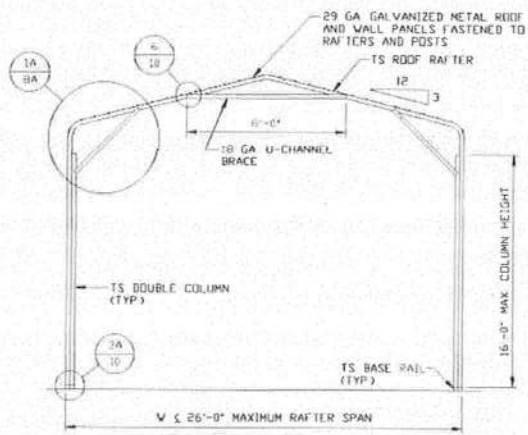

TYPICAL RAFTER/COLUMN FRAME SECTION
SCALE: NTS

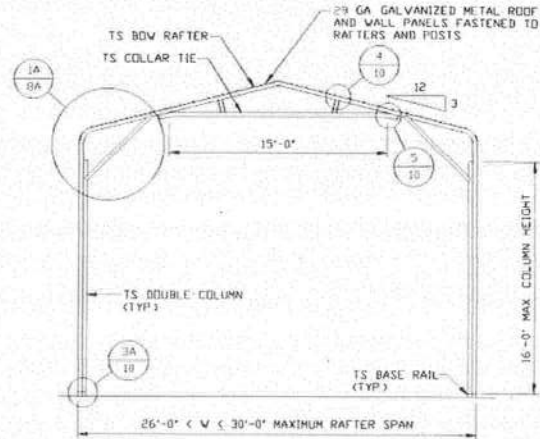

TYPICAL RAFTER/COLUMN END FRAME SECTION
SCALE: NTS

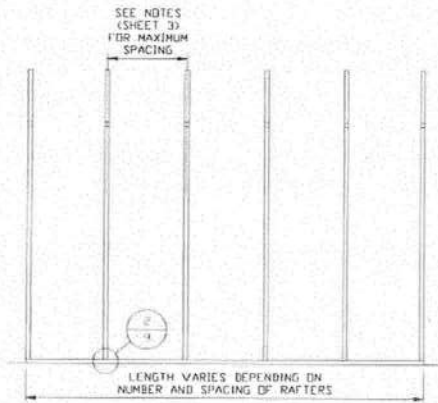

TYPICAL RAFTER/COLUMN SIDE FRAMING SECTION
SCALE: NTS

**MOORE AND ASSOCIATES
ENGINEERING AND CONSULTING, INC.**

DRAWN BY: LT

CHECKED BY: PDH

PROJECT MGR: VSM

CLIENT: SBSI

STEEL BUILDINGS AND STRUCTURES, INC.
P.O. BOX 1287,
MOUNT AIRY, NC 27030
30'-0" x 20'-0" FULLY OPEN STRUCTURE

DATE: 12-11-20

SHT. 7A

SCALE: NTS

DWG. NO: SK-1

JOB NO: 18068S/18156S
18290S/20019S/20324S

REV: 9

THIS DOCUMENT IS THE PROPERTY OF MOORE AND ASSOCIATES ENGINEERING AND CONSULTING. THE UNAUTHORIZED REPRODUCTION, COPYING, OR OTHERWISE USE OF THIS DOCUMENT IS STRICTLY PROHIBITED AND ANY INFRINGEMENT THEREUPON MAY BE SUBJECT TO LEGAL ACTION.

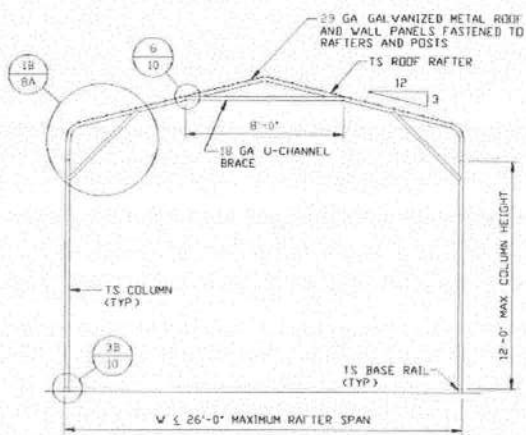

TYPICAL RAFTER/COLUMN FRAME SECTION
SCALE: NTS

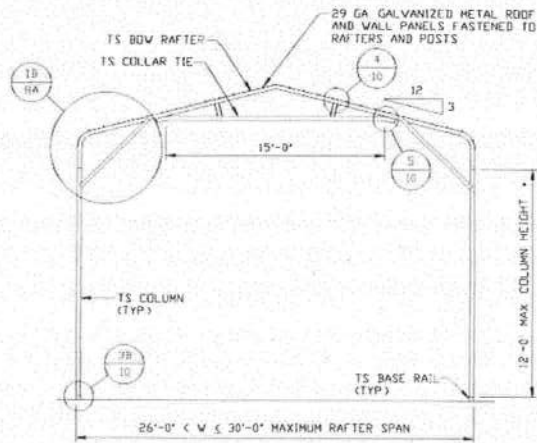

TYPICAL RAFTER/COLUMN END FRAME SECTION
SCALE: NTS

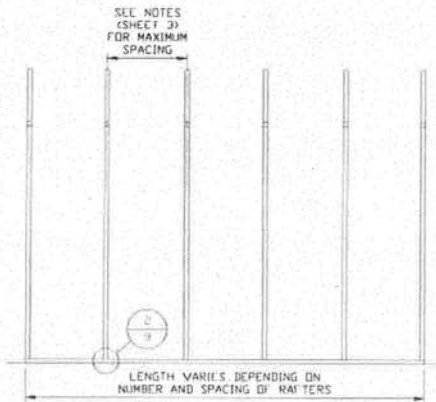

TYPICAL RAFTER/COLUMN SIDE FRAMING SECTION
SCALE: NTS

**MOORE AND ASSOCIATES
ENGINEERING AND CONSULTING, INC.**

DRAWN BY: LT

CHECKED BY: PDH

PROJECT MGR: VSM

CLIENT: SBSI

STEEL BUILDINGS AND STRUCTURES, INC.
P.O. BOX 1287,
MOUNT AIRY, NC 27030
30'-0" x 20'-0" FULLY OPEN STRUCTURE

DATE: 12-11-20

SCALE: NTS

DWG. NO: SK-1

JOB NO: 18068S/18156S
18290S/20019S/20324S

SHT. 7B

REV: 9

HIS DOCUMENT IS THE PROPERTY OF MOORE AND ASSOCIATES ENGINEERING AND CONSULTING. THE UNAUTHORIZED REPRODUCTION, COPYING, OR OTHERWISE USE OF HIS DOCUMENT IS STRICTLY PROHIBITED AND ANY INFRINGEMENT THEREUPON MAY BE SUBJECT TO LEGAL ACTION.

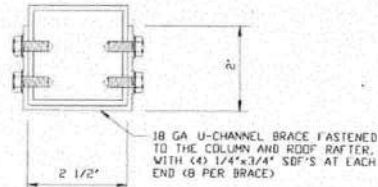
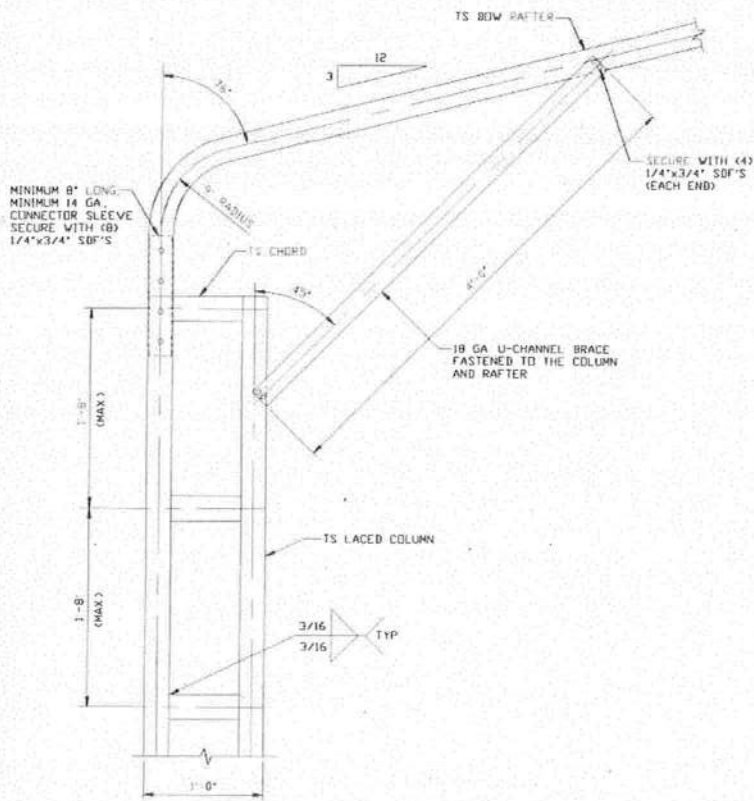

BRACE SECTION
SCALE: NTS

**BOW EAVE RAFTER/CORNER POST
CONNECTION DETAIL
FOR HEIGHTS 16'-0" < TO ≤ 20'-0"**
SCALE: NTS

1

**MOORE AND ASSOCIATES
ENGINEERING AND CONSULTING, INC.**

DRAWN BY: LT

CHECKED BY: PDH

PROJECT MGR: VSM

CLIENT: SBST

STEEL BUILDINGS AND STRUCTURES, INC.
P.O. BOX 1287,
MOUNT AIRY, NC 27030
30'-0" x 20'-0" FULLY OPEN STRUCTURE

DATE: 12-11-20

SHT. 8

SCALE: NTS

DWG. NO: SK-1

JOB NO: 18068S/18156S
18290S/P0019S/P0324S

REV: 9

THIS DOCUMENT IS THE PROPERTY OF MOORE AND ASSOCIATES ENGINEERING AND CONSULTING. THE UNAUTHORIZED REPRODUCTION, COPYING, OR OTHERWISE USE OF THIS DOCUMENT IS STRICTLY PROHIBITED AND ANY INFRINGEMENT THEREUPON MAY BE SUBJECT TO LEGAL ACTION.

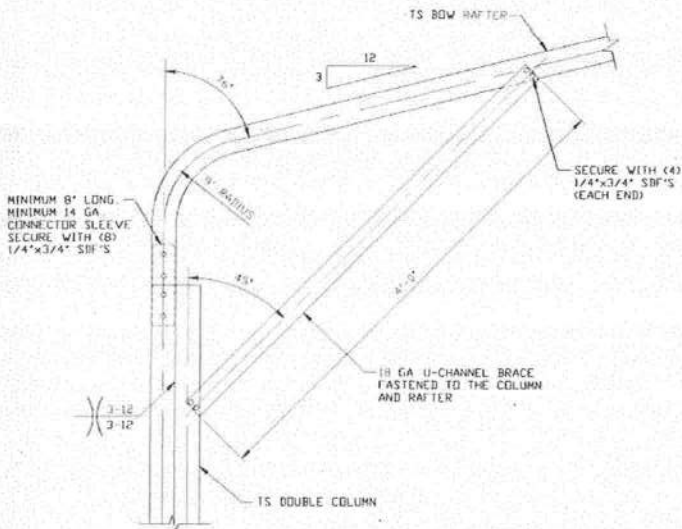

1A
BOW EAVE RAFTER/CORNER POST CONNECTION DETAIL
FOR HEIGHTS 12'-0" < TO <= 16'-0"
 SCALE: NTS

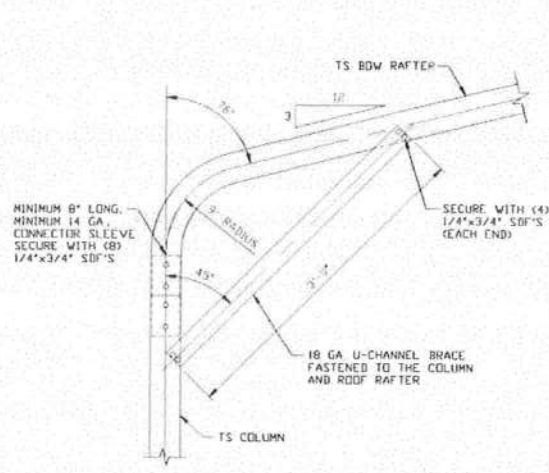

1B
BOW EAVE RAFTER/CORNER POST CONNECTION DETAIL
FOR HEIGHTS <= 12'-0"
 SCALE: NTS

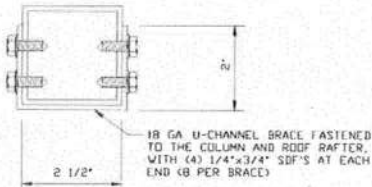

BRACE SECTION
 SCALE: NTS

MOORE AND ASSOCIATES
ENGINEERING AND CONSULTING, INC.

DRAWN BY: LT

CHECKED BY: PDH

PROJECT MGR: WSM

CLIENT: SBSI

STEEL BUILDINGS AND STRUCTURES, INC.

P.O. BOX 1287,

MOUNT AIRY, NC 27030

30'-0" x 20'-0" FULLY OPEN STRUCTURE

DATE: 12-11-20

SHT. 8A

SCALE: NTS

DWG. NO SK-1

JOB NO 18068S/18156S

18290S/20019S/20324S

REV: 9

THIS DOCUMENT IS THE PROPERTY OF MOORE AND ASSOCIATES ENGINEERING AND CONSULTING. THE UNAUTHORIZED REPRODUCTION, COPYING, OR OTHERWISE USE OF THIS DOCUMENT IS STRICTLY PROHIBITED AND ANY INFRINGEMENT THEREUPON MAY BE SUBJECT TO LEGAL ACTION.

BASE RAIL ANCHORAGE OPTIONS

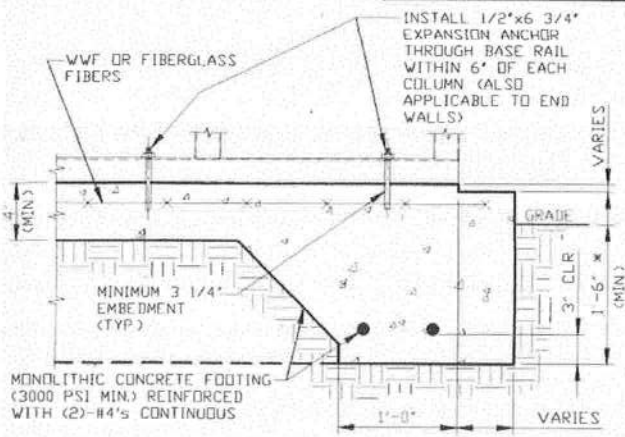

2 CONCRETE MONOLITHIC SLAB BASE RAIL ANCHORAGE

SCALE: NTS
MINIMUM ANCHOR EDGE DISTANCE IS 4"
* COORDINATE WITH LOCAL CODES/ORD

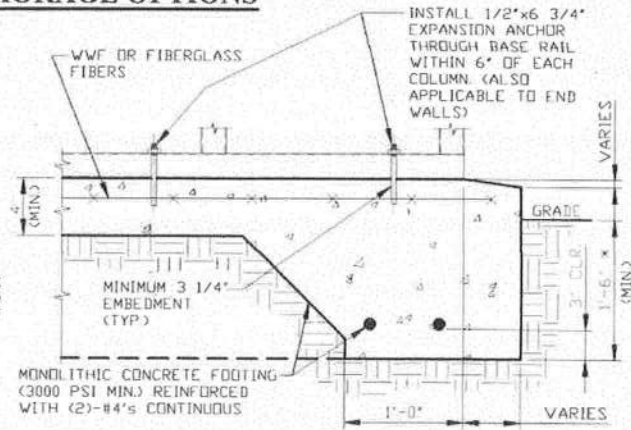

2A CONCRETE SLAB BASE RAIL ANCHORAGE

SCALE: NTS
MINIMUM ANCHOR EDGE DISTANCE IS 4"
* COORDINATE WITH LOCAL CODES/ORD

GENERAL NOTES

NOTE: CONCRETE MONOLITHIC SLAB DESIGN BASED ON MINIMUM SOIL BEARING CAPACITY OF 1,500 PSF

CONCRETE:

CONCRETE SHALL HAVE A MINIMUM SPECIFIED COMPRESSIVE STRENGTH OF 3,000 PSI AT 28 DAYS

COVER OVER REINFORCING STEEL:

FOR FOUNDATIONS, MINIMUM CONCRETE COVER OVER REINFORCING BARS SHALL BE PER ACI-318:

3" IN FOUNDATIONS WHERE THE CONCRETE IS CAST AGAINST AND PERMANENTLY IN CONTACT WITH THE EARTH OR EXPOSED TO THE EARTH OR WEATHER, AND 1 1/2" ELSEWHERE

REINFORCING STEEL:

THE TURNDOWN REINFORCING STEEL SHALL BE ASTM A615 GRADE 60 THE SLAB REINFORCEMENT SHALL BE WELDED WIRE FABRIC MEETING ASTM A185 OR FIBERGLASS FIBER REINFORCEMENT

REINFORCEMENT MAY BE BENT IN THE SHOP OR THE FIELD PROVIDED:

1. REINFORCEMENT IS BENT COLD
2. THE DIAMETER OF THE BEND, MEASURED ON THE INSIDE OF THE BAR, IS NOT LESS THAN SIX-BAR DIAMETERS
3. REINFORCEMENT PARTIALLY EMBEDDED IN CONCRETE SHALL NOT BE FIELD BENT

HELIX ANCHOR NOTES:

1. FOR VERY DENSE AND/OR CEMENTED SANDS, COARSE GRAVEL AND COBBLES, CALICHE, PRELOADED SILTS AND CLAYS, USE MINIMUM (2) 4" HELICES WITH MINIMUM 30" EMBEDMENT OR SINGLE 6" HELIX WITH MINIMUM 50" EMBEDMENT
2. FOR CORAL USE MINIMUM (2) 4" HELICES WITH MINIMUM 30" EMBEDMENT OR SINGLE 6" HELIX WITH MINIMUM 50" EMBEDMENT
3. FOR MEDIUM DENSE COARSE SANDS, SANDY GRAVELS, VERY STIFF SILTS, AND CLAYS USE MINIMUM (2) 4" HELICES WITH MINIMUM 30 INCH EMBEDMENT OR SINGLE 6" HELIX WITH MINIMUM 50" EMBEDMENT
4. FOR LOOSE TO MEDIUM DENSE SANDS, FIRM TO STIFF CLAYS AND SILTS ALLUVIAL FILL, USE MINIMUM (2) 6" HELICES WITH MINIMUM 50" EMBEDMENT
5. FOR VERY LOSE TO MEDIUM DENSE SANDS, FIRM TO STIFFER CLAYS AND SILTS, ALLUVIAL FILL, USE MINIMUM (2) 8" HELICES WITH MINIMUM 60" EMBEDMENT

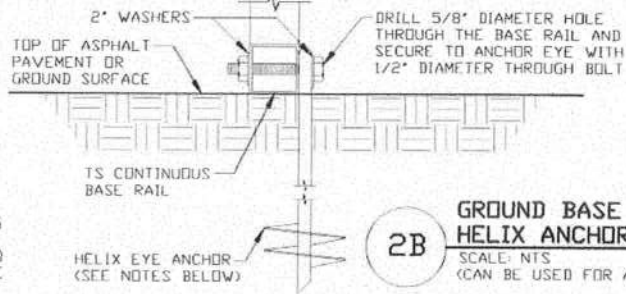

2B GROUND BASE HELIX ANCHORAGE

SCALE: NTS
(CAN BE USED FOR ASPHALT)

**MOORE AND ASSOCIATES
ENGINEERING AND CONSULTING, INC.**

DRAWN BY: LT

CHECKED BY: PDH

PROJECT MGR: WSM

CLIENT: SBSI

STEEL BUILDINGS AND STRUCTURES, INC.

P.O. BOX 1287,
MOUNT AIRY, NC 27030

30'-0"x20'-0" FULLY OPEN STRUCTURE

DATE: 12-11-20

SHT. 9

SCALE: NTS

DWG. NO: SK-1

JOB NO: 18068S/18156S
18290S/20019S/20324S

REV: 9

THIS DOCUMENT IS THE PROPERTY OF MOORE AND ASSOCIATES ENGINEERING AND CONSULTING. THE UNAUTHORIZED REPRODUCTION, COPYING, OR OTHERWISE USE OF THIS DOCUMENT IS STRICTLY PROHIBITED AND ANY INFRINGEMENT THEREUPON MAY BE SUBJECT TO LEGAL ACTION.

ADDITIONAL BASE RAIL ANCHORAGE OPTION

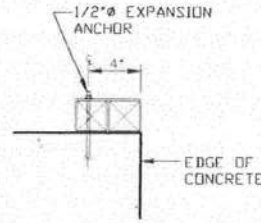
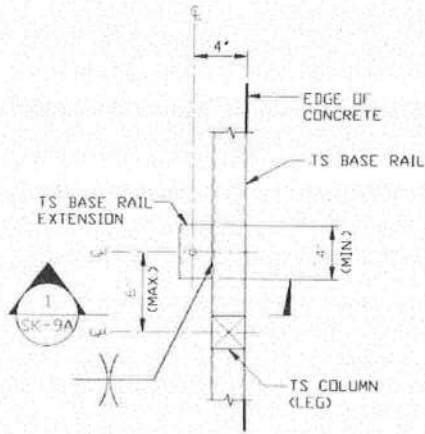

SECTION 1
SCALE: NTS
SK-9A

TYPICAL ANCHOR DETAIL WHEN BASE RAIL IS NEAR EDGE OF CONCRETE

SCALE: NTS

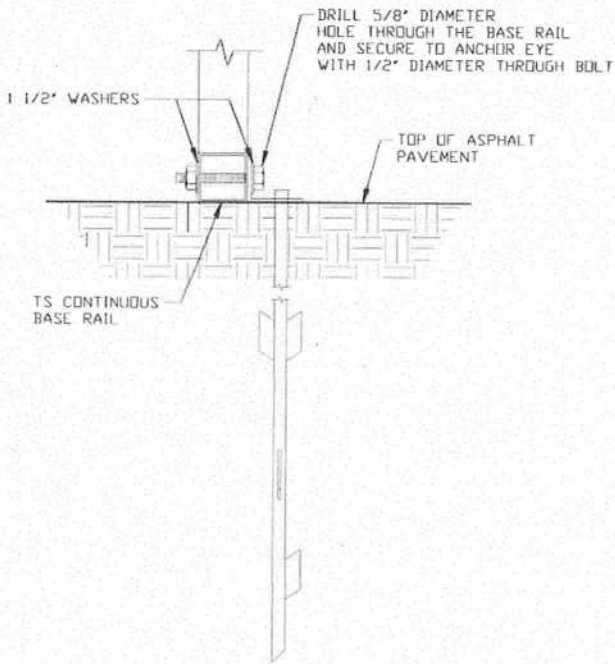

2C **ASPHALT BASE ANCHORAGE**
SCALE: NTS

**MOORE AND ASSOCIATES
ENGINEERING AND CONSULTING, INC.**

DRAWN BY: LT

CHECKED BY: PDH

PROJECT MGR: VSM

CLIENT: SBSI

STEEL BUILDINGS AND STRUCTURES, INC.
P.O. BOX 1287,
MOUNT AIRY, NC 27030
30'-0" x 20'-0" FULLY OPEN STRUCTURE

DATE: 12-11-20

SCALE: NTS

DWG. NO: SK-1

JOB NO: 18068S/18156S
18290S/20019S/20324S

SHT. 9A

REV: 9

HIS DOCUMENT IS THE PROPERTY OF MOORE AND ASSOCIATES ENGINEERING AND CONSULTING, INC. THE UNAUTHORIZED REPRODUCTION, COPYING, OR OTHERWISE USE OF HIS DOCUMENT IS STRICTLY PROHIBITED AND ANY INFRINGEMENT THEREUPON MAY BE SUBJECT TO LEGAL ACTION.

CONNECTION DETAILS

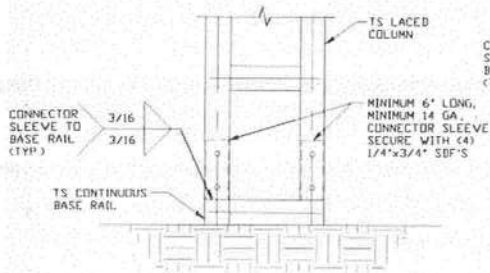

3 POST/BASE RAIL CONNECTION DETAIL
SCALE: NTS

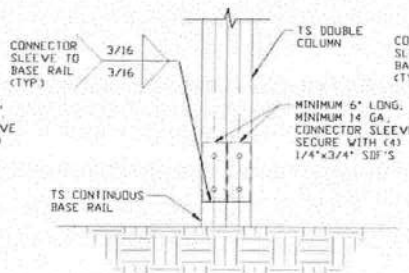

3A POST/BASE RAIL CONNECTION DETAIL
SCALE: NTS

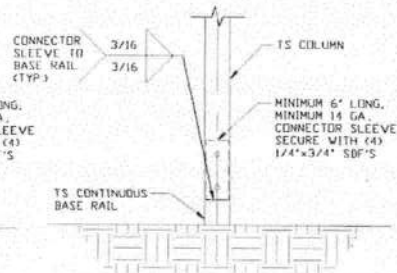

3B POST/BASE RAIL CONNECTION DETAIL
SCALE: NTS

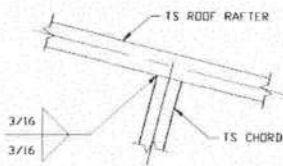

4 RAFTER TO CHORD CONNECTION DETAIL
SCALE: NTS

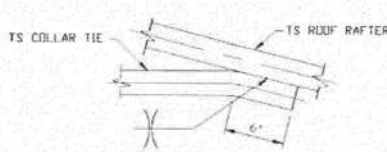

5 COLLAR TIE CONNECTION DETAIL
SCALE: NTS

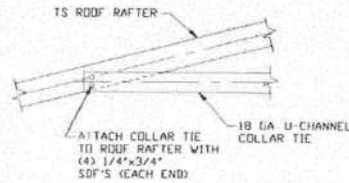

6 COLLAR TIE CONNECTION DETAIL
SCALE: NTS

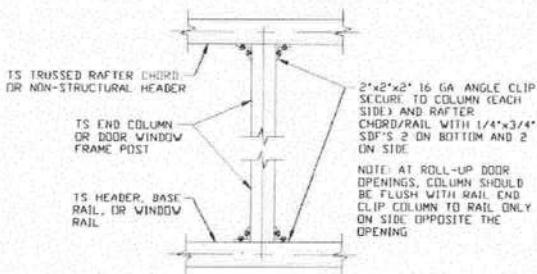

7 COLUMN TO HEADER, BASE RAIL, OR WINDOW RAIL CONNECTION DETAIL
SCALE: NTS

**MOORE AND ASSOCIATES
ENGINEERING AND CONSULTING, INC.**

DRAWN BY: LT
CHECKED BY: PDH
PROJECT MGR: VSM
CLIENT: SBSI

STEEL BUILDINGS AND STRUCTURES, INC.
P.O. BOX 1287,
MOUNT AIRY, NC 27030
30'-0" x 20'-0" FULLY OPEN STRUCTURE

DATE: 12-11-20
SCALE: NTS
SHT. 10
DWG. NO: SK-1
JOB NO: 18068S/18156S
18290S/20019S/20324S
REV: 9

THIS DOCUMENT IS THE PROPERTY OF MOORE AND ASSOCIATES ENGINEERING AND CONSULTING. THE UNAUTHORIZED REPRODUCTION, COPYING, OR OTHERWISE USE OF THIS DOCUMENT IS STRICTLY PROHIBITED AND ANY INFRINGEMENT THEREUPON MAY BE SUBJECT TO LEGAL ACTION.

BOX EAVE GABLE END OPTION

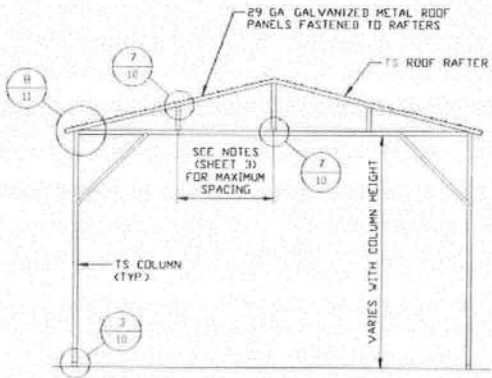

TYPICAL GABLE END FRAMING SECTION
SCALE: NTS

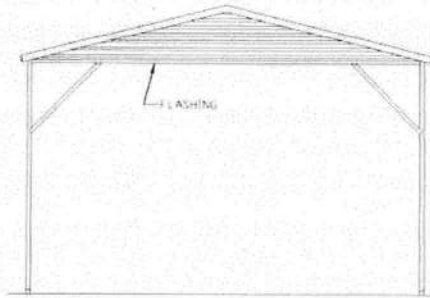

TYPICAL GABLE END ELEVATION
SCALE: NTS

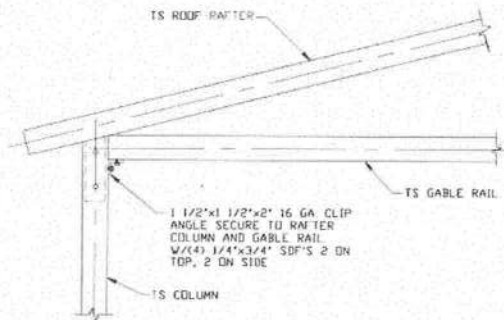

BOX EAVE RAFTER GABLE RAIL TO RAFTER COLUMN CONNECTION DETAIL

SCALE: NTS
NOTE: KNEE BRACE NOT SHOWN FOR CLARITY

8

**MOORE AND ASSOCIATES
ENGINEERING AND CONSULTING, INC.**

DRAWN BY: LT

CHECKED BY: PDH

PROJECT MGR: VSM

CLIENT: SBST

STEEL BUILDINGS AND STRUCTURES, INC.
P.O. BOX 1287,
MOUNT AIRY, NC 27030
30'-0" X 20'-0" FULLY OPEN STRUCTURE

DATE: 12-11-20

SHT. 11

SCALE: NTS

DWG. NO: SK-1

JOB NO: 18068S/18156S
18290S/20019S/20324S

REV: 9

THIS DOCUMENT IS THE PROPERTY OF MOORE AND ASSOCIATES ENGINEERING AND CONSULTING. THE UNAUTHORIZED REPRODUCTION, COPYING, OR OTHERWISE USE OF THIS DOCUMENT IS STRICTLY PROHIBITED AND ANY INFRINGEMENT THEREUPON MAY BE SUBJECT TO LEGAL ACTION.

BOW EAVE GABLE END OPTION

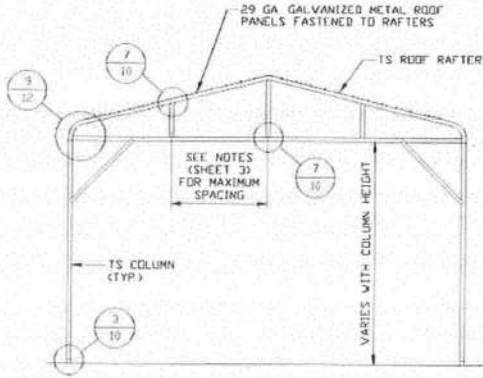

TYPICAL GABLE END FRAMING SECTION
SCALE: NTS

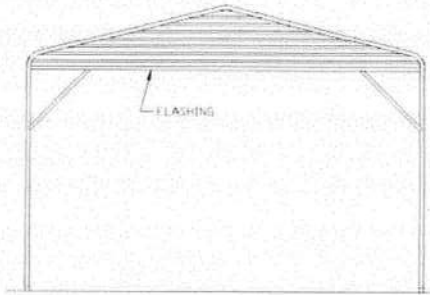

TYPICAL GABLE END ELEVATION
SCALE: NTS

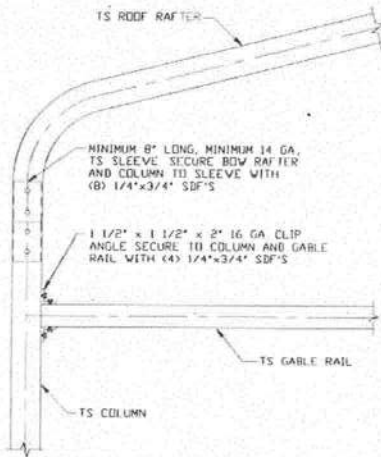

BOW EAVE RAFTER GABLE RAIL TO RAFTER COLUMN CONNECTION DETAIL

SCALE: NTS
NOTE: KNEE BRACE NOT SHOWN FOR CLARITY

9

**MOORE AND ASSOCIATES
ENGINEERING AND CONSULTING, INC.**

DRAWN BY: LT

CHECKED BY: PDH

PROJECT MGR: WSM

CLIENT: SBSI

STEEL BUILDINGS AND STRUCTURES, INC.

P.O. BOX 1287,
MOUNT AIRY, NC 27030

30'-0" x 20'-0" FULLY OPEN STRUCTURE

DATE: 12-11-20

SHT. 12

SCALE: NTS

DWG. NO: SK-1

JOB NO: 18068S/18156S
18290S/20019S/20324S

REV: 9

THIS DOCUMENT IS THE PROPERTY OF MOORE AND ASSOCIATES ENGINEERING AND CONSULTING. THE UNAUTHORIZED REPRODUCTION, COPYING, OR OTHERWISE USE OF THIS DOCUMENT IS STRICTLY PROHIBITED AND ANY INFRINGEMENT THEREUPON MAY BE SUBJECT TO LEGAL ACTION.

BOX EAVE EXTRA SIDE PANEL OPTION

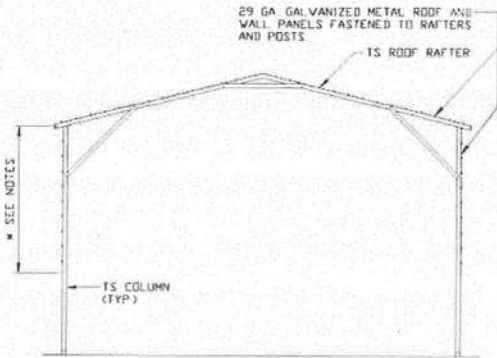

**TYPICAL END FRAME SECTION
EXTRA SIDE PANELS**

SCALE: NTS

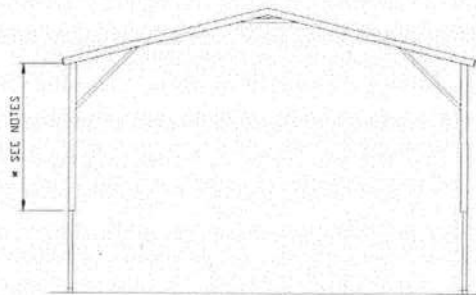

**TYPICAL END ELEVATION
EXTRA SIDE PANELS**

SCALE: NTS

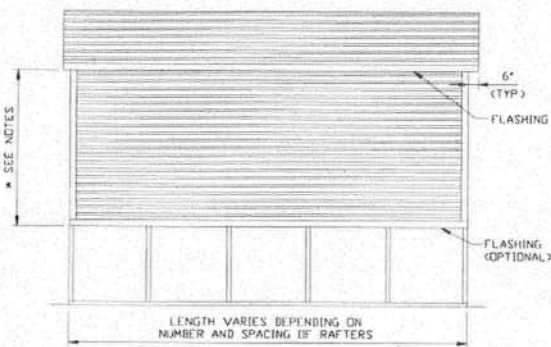

**TYPICAL SIDE ELEVATION
EXTRA SIDE PANELS**

SCALE: NTS

NOTES:

- * FULL SIDING (FOR EAVE HEIGHTS 12'-0" < TO ≤ 20'-0")
- * NO SIDING (FOR EAVE HEIGHTS 10'-0" < TO ≤ 12'-0" WITH SINGLE COLUMN CONFIGURATION)
- * 3'-0" MAX (FOR EAVE HEIGHTS ≤ 10'-0")

**MOORE AND ASSOCIATES
ENGINEERING AND CONSULTING, INC.**

DRAWN BY: LT

CHECKED BY: PDH

PROJECT MGR: WSH

CLIENT: SBSI

STEEL BUILDINGS AND STRUCTURES, INC.

P.O. BOX 1287,
MOUNT AIRY, NC 27030

30'-0" x 20'-0" FULLY OPEN STRUCTURE

DATE: 12-11-20

SHT. 13

SCALE: NTS

DWG. NO SK-1

JOB NO 18068S/18156S
18290S/20019S/20324S

REV: 9

HIS DOCUMENT IS THE PROPERTY OF MOORE AND ASSOCIATES ENGINEERING AND CONSULTING. THE UNAUTHORIZED REPRODUCTION, COPYING, OR OTHERWISE USE OF HIS DOCUMENT IS STRICTLY PROHIBITED AND ANY INFRINGEMENT THEREUPON MAY BE SUBJECT TO LEGAL ACTION.

BOW EAVE EXTRA SIDE PANEL OPTION

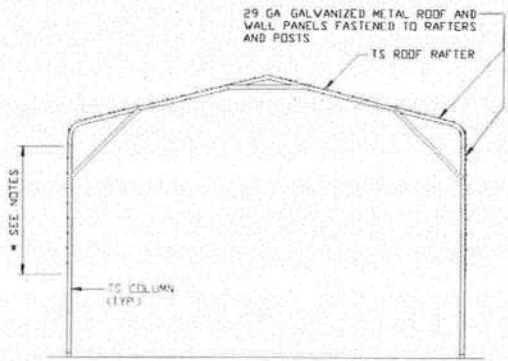

**TYPICAL END FRAME SECTION
EXTRA SIDE PANELS**

SCALE: NTS

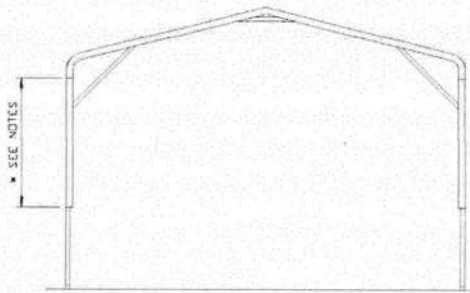

**TYPICAL END ELEVATION
EXTRA SIDE PANELS**

SCALE: NTS

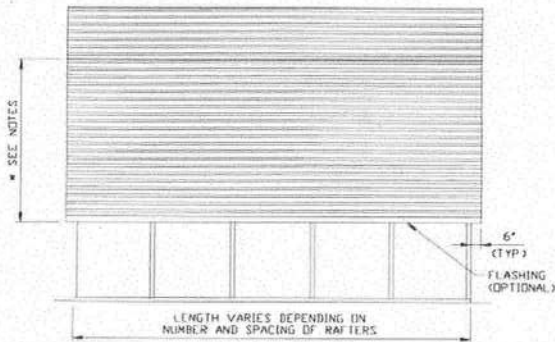

**TYPICAL SIDE ELEVATION
EXTRA SIDE PANELS**

SCALE: NTS

NOTES:

- * FULL SIDING (FOR EAVE HEIGHTS 12'-0" < TO ≤ 20'-0")
- * NO SIDING (FOR EAVE HEIGHTS 10'-0" < TO ≤ 12'-0" WITH SINGLE COLUMN CONFIGURATION)
- * 3'-0" MAX (FOR EAVE HEIGHTS ≤ 10'-0")

**MOORE AND ASSOCIATES
ENGINEERING AND CONSULTING, INC.**

DRAWN BY: LT

CHECKED BY: PDH

PROJECT MGR: VSM

CLIENT: SBSI

STEEL BUILDINGS AND STRUCTURES, INC.

P.O. BOX 1287,
MOUNT AIRY, NC 27030

30'-0" x 20'-0" FULLY OPEN STRUCTURE

DATE: 12-11-20

SHT. 14

SCALE: NTS

DWG. NO: SK-1

JOB NO: 18069S/18156S
18290S/20019S/20324S

REV: 9

HIS DOCUMENT IS THE PROPERTY OF MOORE AND ASSOCIATES ENGINEERING AND CONSULTING. THE UNAUTHORIZED REPRODUCTION, COPYING, OR OTHERWISE USE OF HIS DOCUMENT IS STRICTLY PROHIBITED AND ANY INFRINGEMENT THEREUPON MAY BE SUBJECT TO LEGAL ACTION.

VERTICAL ROOF OPTION

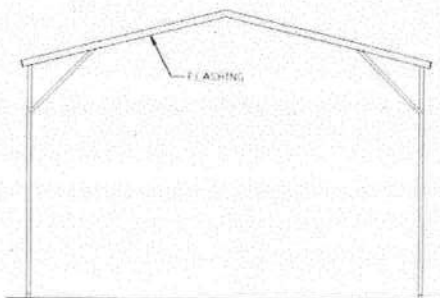

**TYPICAL END ELEVATION
VERTICAL ROOF**

SCALE: NTS

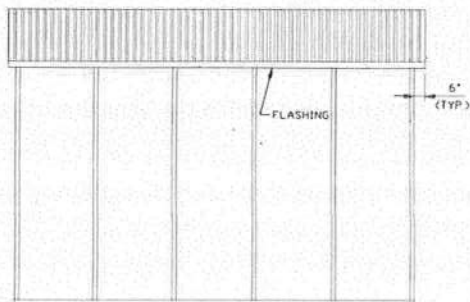

**TYPICAL SIDE ELEVATION
VERTICAL ROOF OPTION**

SCALE: NTS

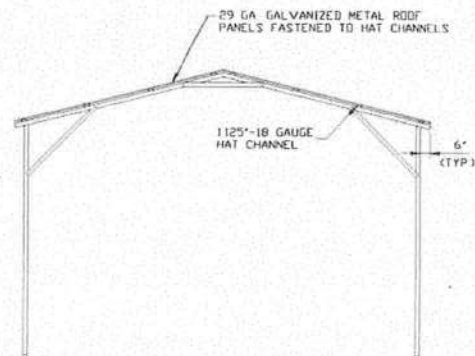

**TYPICAL SECTION
VERTICAL ROOF OPTION**

SCALE: NTS

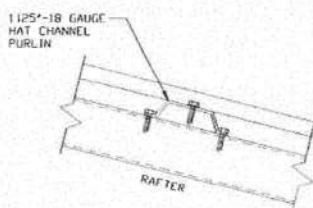

ROOF PANEL ATTACHMENT

(ALTERNATE FOR VERTICAL ROOF PANELS)

SCALE: NTS

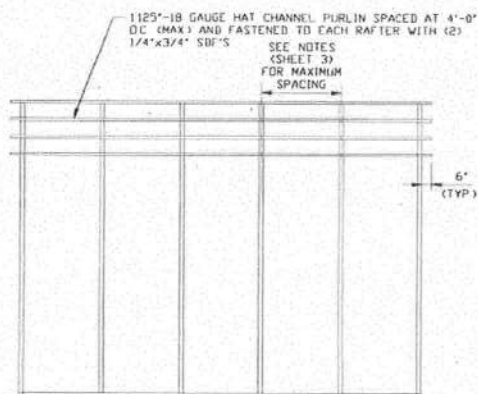

**TYPICAL SIDE FRAMING SECTION
VERTICAL ROOF OPTION**

SCALE: NTS

**MOORE AND ASSOCIATES
ENGINEERING AND CONSULTING, INC.**

DRAWN BY: LT

CHECKED BY: PDH

PROJECT MGR: VSM

CLIENT: SBSI

STEEL BUILDINGS AND STRUCTURES, INC.
P.O. BOX 1287,
MOUNT AIRY, NC 27030
30'-0" x 20'-0" FULLY OPEN STRUCTURE

DATE: 12-11-20

SHT. 15

SCALE: NTS

DWG. NO: SK-1

JOB NO: 1806BS/1815GS
1829GS/20019S/20324S

REV: 9

HIS DOCUMENT IS THE PROPERTY OF MOORE AND ASSOCIATES ENGINEERING AND CONSULTING. THE UNAUTHORIZED REPRODUCTION, COPYING, OR OTHERWISE USE OF HIS DOCUMENT IS STRICTLY PROHIBITED AND ANY INFRINGEMENT THEREUPON MAY BE SUBJECT TO LEGAL ACTION.

OPTIONAL BASE RAIL ON GRADE APPLICATION

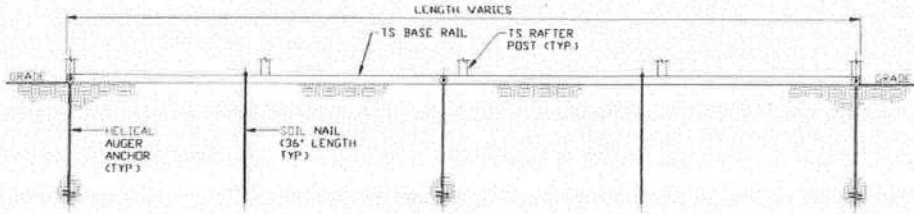

SECTION 2
SCALE: NTS

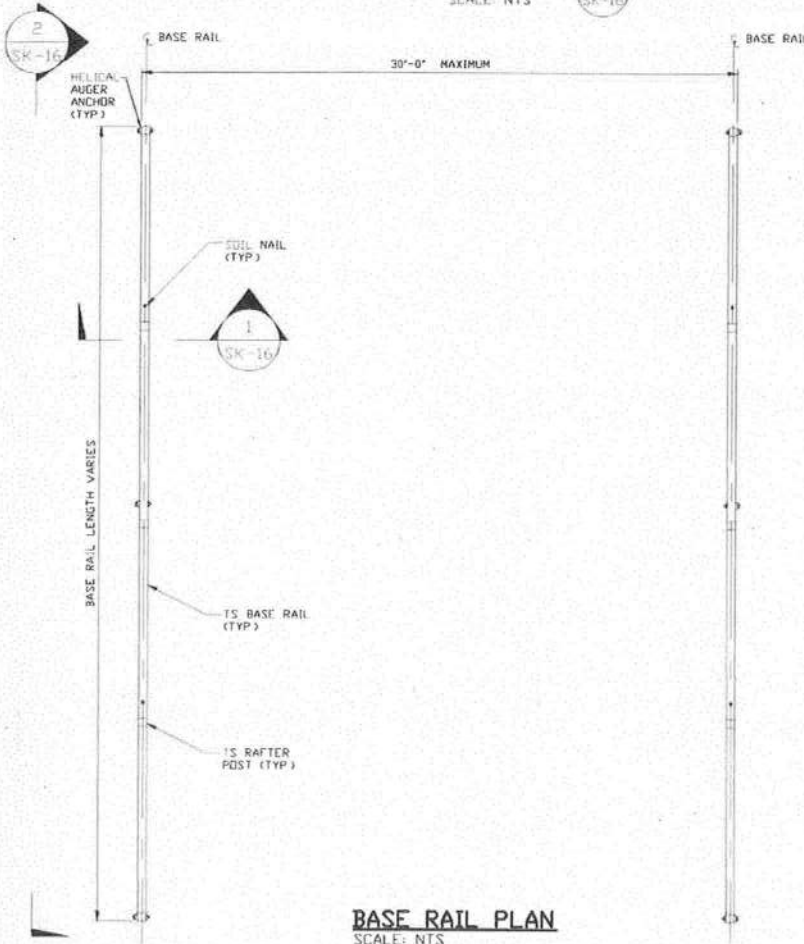

BASE RAIL PLAN
SCALE: NTS

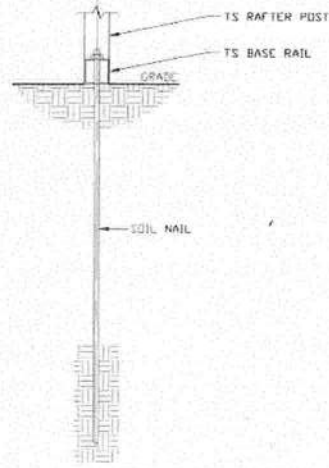

SECTION 1
SCALE: NTS

| HELIX ANCHOR | |
|--------------|---------------------------|
| SIDE LENGTH | MAXIMUM SPACING |
| VARIES | 10'-0" (EVERY OTHER POST) |

**MOORE AND ASSOCIATES
ENGINEERING AND CONSULTING, INC.**

DRAWN BY: LT

CHECKED BY: PDH

PROJECT MGR: WSM

CLIENT: SBSI

STEEL BUILDINGS AND STRUCTURES, INC.
P.O. BOX 1287,
MOUNT AIRY, NC 27030

30'-0"x20'-0" FULLY OPEN STRUCTURE

DATE: 12-11-20

SHT. 16

SCALE: NTS

DWG. NO: SK-1

**JOB NO: 10068S/10156S
10290S/20019S/20324S**

REV: 9

THIS DOCUMENT IS THE PROPERTY OF MOORE AND ASSOCIATES ENGINEERING AND CONSULTING. THE UNAUTHORIZED REPRODUCTION, COPYING, OR OTHERWISE USE OF THIS DOCUMENT IS STRICTLY PROHIBITED AND ANY INFRINGEMENT THEREUPON MAY BE SUBJECT TO LEGAL ACTION.

OPTIONAL BASE RAIL ON TIMBER BEAM

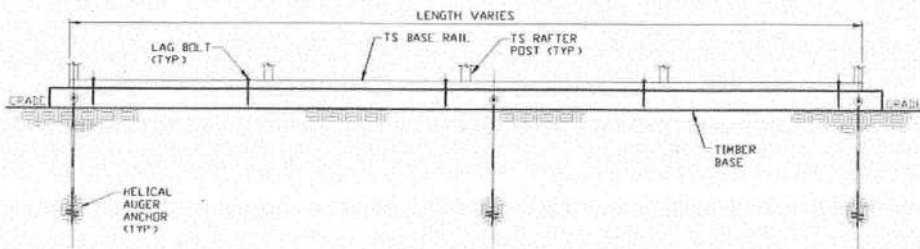

SECTION 2
SCALE: NTS
SK-17

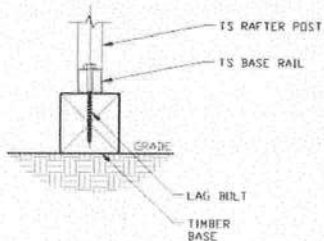
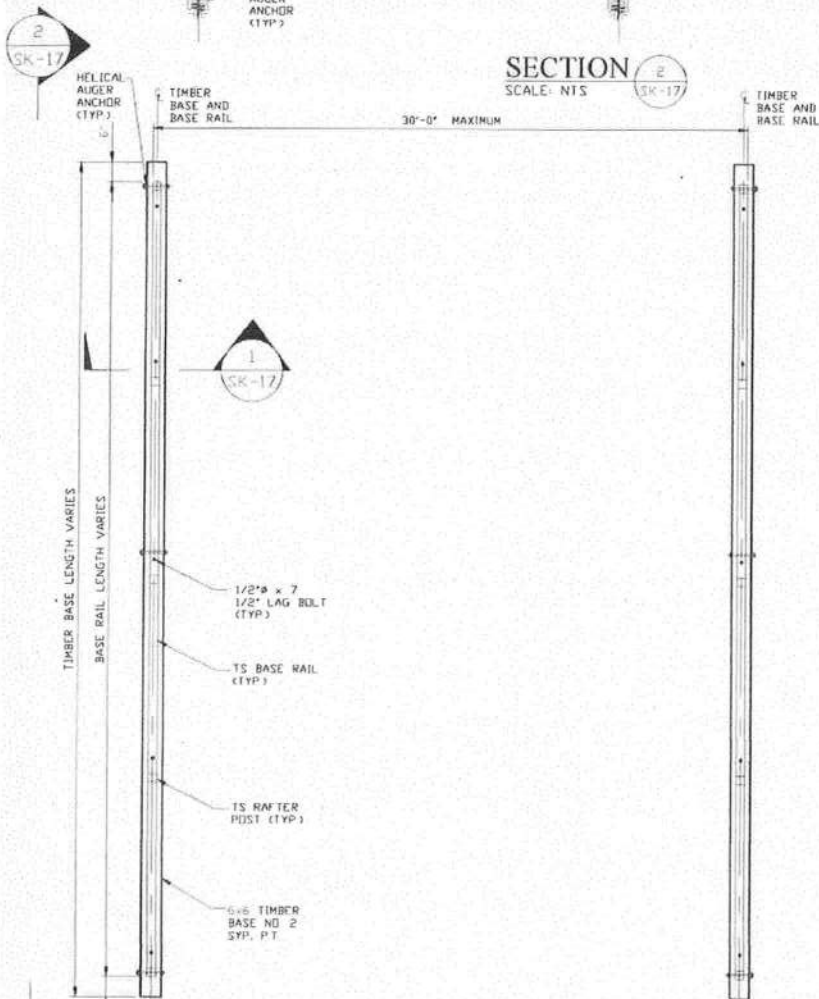

SECTION 1
SCALE: NTS
SK-17

TIMBER FOOTING PLAN
SCALE: NTS

| HELIX ANCHOR | |
|--------------|---------------------------|
| SIDE LENGTH | MAXIMUM SPACING |
| VARIES | 10'-0" (EVERY OTHER POST) |

**MOORE AND ASSOCIATES
ENGINEERING AND CONSULTING, INC.**

DRAWN BY: LT
CHECKED BY: PDH

STEEL BUILDINGS AND STRUCTURES, INC.
P.O. BOX 1287,
MOUNT AIRY, NC 27030
30'-0"x20'-0" FULLY OPEN STRUCTURE

PROJECT MGR: WSM

DATE: 12-11-20

SCALE: NTS

JOB NO: 10069S/18156S
18290S/20019S/20324S

CLIENT: SBSI

SHT. 17

DWG. NO: SK-1

REV. 9

THIS DOCUMENT IS THE PROPERTY OF MOORE AND ASSOCIATES ENGINEERING AND CONSULTING. THE UNAUTHORIZED REPRODUCTION, COPYING, OR OTHERWISE USE OF THIS DOCUMENT IS STRICTLY PROHIBITED AND ANY INFRINGEMENT THEREUPON MAY BE SUBJECT TO LEGAL ACTION.

OPTIONAL BASE RAIL ON TIMBER BEAM WITH SOIL NAIL

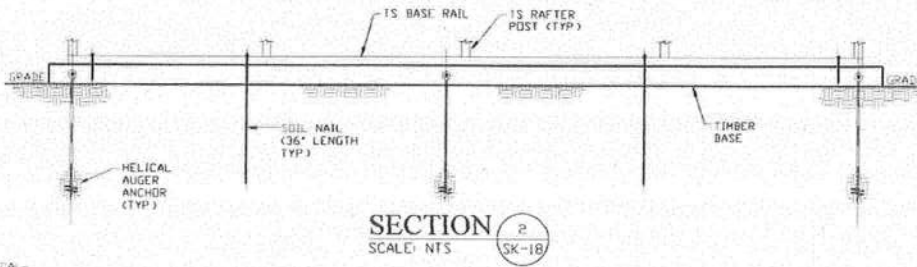

SECTION 2
SCALE: NTS
SK-1B

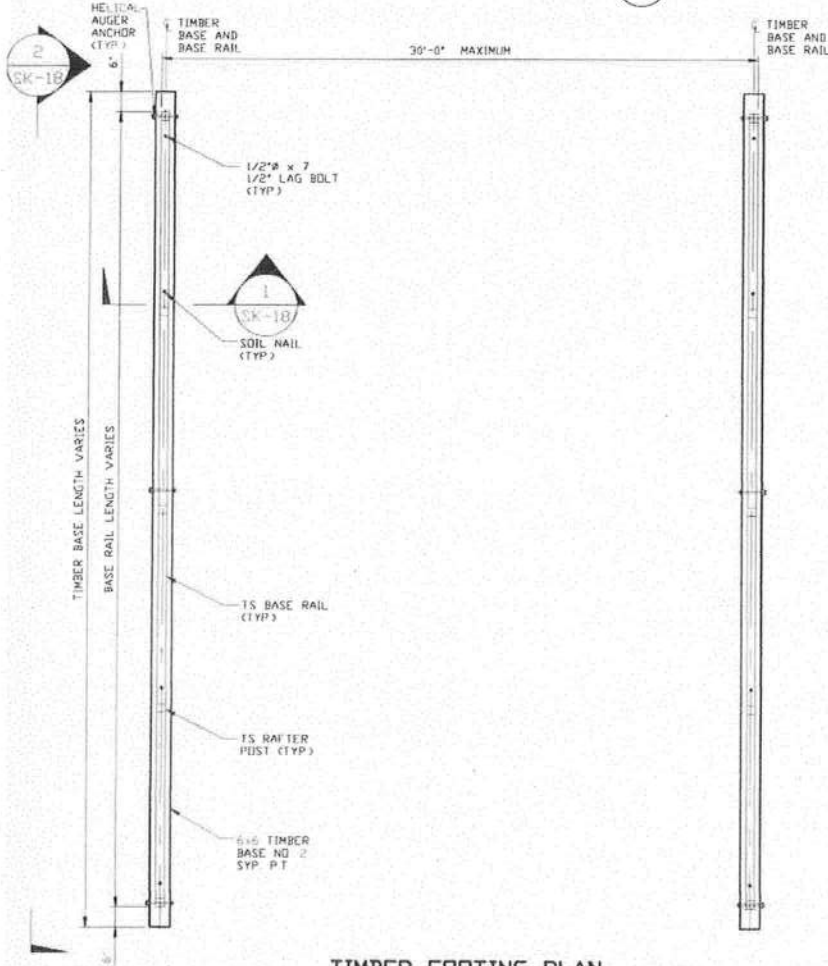

TIMBER FOOTING PLAN
SCALE: NTS

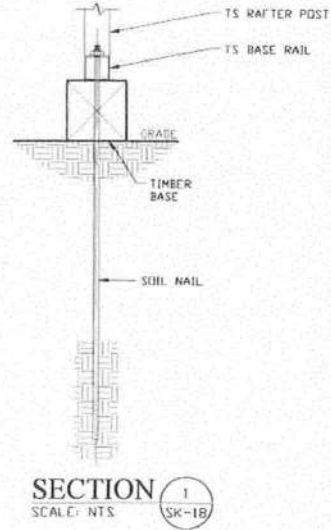

SECTION 1
SCALE: NTS
SK-1B

| HELIX ANCHOR | |
|--------------|---------------------------|
| SIDE LENGTH | MAXIMUM SPACING |
| VARIES | 10'-0" (EVERY OTHER POST) |

MOORE AND ASSOCIATES
ENGINEERING AND CONSULTING, INC.

DRAWN BY: LT
CHECKED BY: PDH

STEEL BUILDINGS AND STRUCTURES, INC.
P.O. BOX 1287,
MOUNT AIRY, NC 27030
30'-0" x 20'-0" FULLY OPEN STRUCTURE

HIS DOCUMENT IS THE PROPERTY OF MOORE AND ASSOCIATES ENGINEERING AND CONSULTING. THE UNAUTHORIZED REPRODUCTION, COPYING, OR OTHERWISE USE OF HIS DOCUMENT IS STRICTLY PROHIBITED AND ANY INFRINGEMENT THEREUPON MAY BE SUBJECT TO LEGAL ACTION.

PROJECT MGR: WSM
CLIENT: SBSI

DATE: 12-11-20
SHT. 10

SCALE: NTS
DWG. NO: SK-1

JOB NO: 18068S/18156S
18290S/20019S/20324S
REV. 9

OPTIONAL CONCRETE STRIP FOOTING

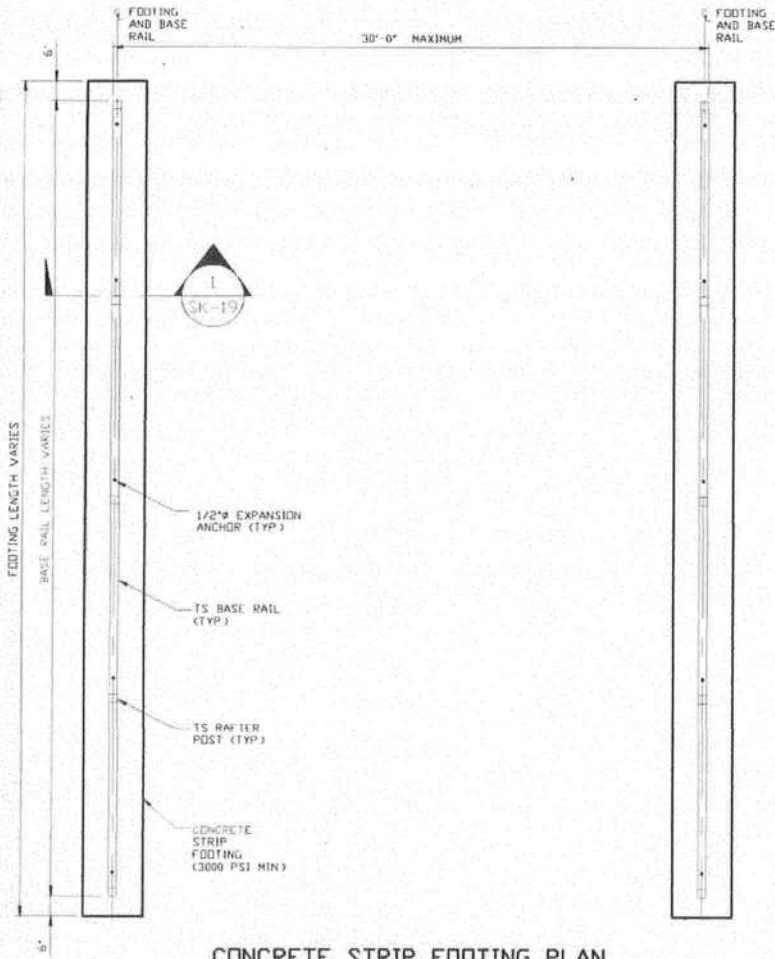

CONCRETE STRIP FOOTING PLAN
SCALE: NTS

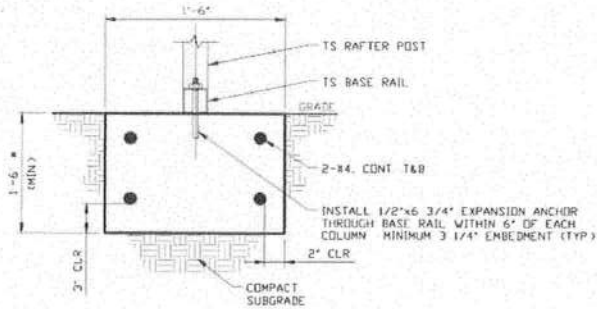

SECTION 1
SCALE: NTS

*COORDINATE WITH LOCAL CODES/ORD

**MOORE AND ASSOCIATES
ENGINEERING AND CONSULTING, INC.**

DRAWN BY: LT

CHECKED BY: PDH

PROJECT MGR: WSM

CLIENT: SBSI

STEEL BUILDINGS AND STRUCTURES, INC.
P.O. BOX 1287,
MOUNT AIRY, NC 27030
30'-0" x 20'-0" FULLY OPEN STRUCTURE

DATE: 12-11-20

SCALE: NTS

**JOB NO: 18068S/18156S
18290S/20019S/20324S**

SHT. 19

DWG. NO: SK-1

REV: 9

HIS DOCUMENT IS THE PROPERTY OF MOORE AND ASSOCIATES ENGINEERING AND CONSULTING. THE UNAUTHORIZED REPRODUCTION, COPYING, OR OTHERWISE USE OF HIS DOCUMENT IS STRICTLY PROHIBITED AND ANY INFRINGEMENT THEREUPON MAY BE SUBJECT TO LEGAL ACTION.