

These drawings, as instruments of service, are the sole property of the architect, and may not be used, copied or reproduced in whole or in part for use on or incorporated into any other job without specific and individual authorization by the architect.

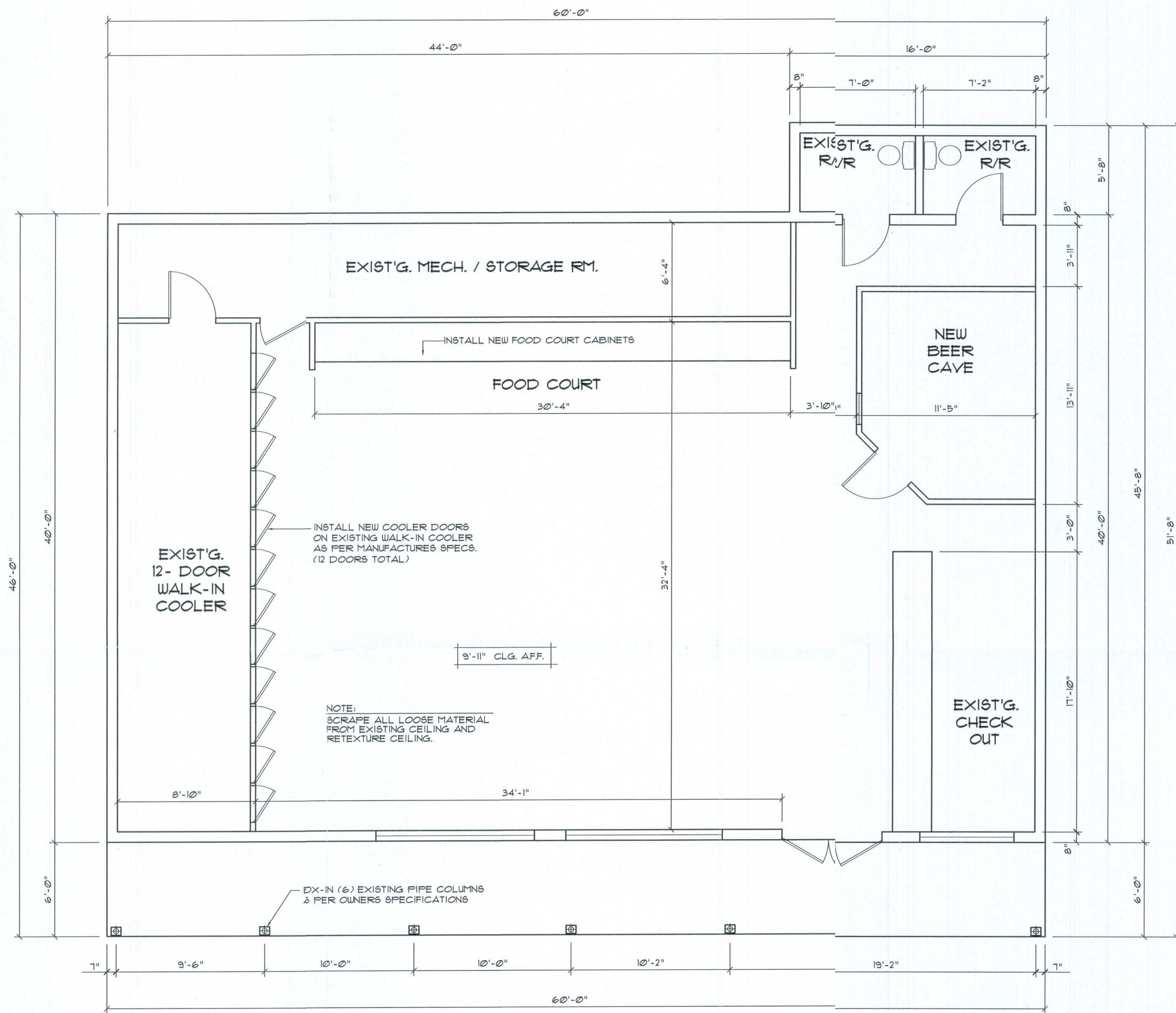

Floor PLAN 2,490 S.F. TOTAL
 SCALE: 1/4" = 1'

REMODEL OF:
S & S FOOD STORE NO. 11
 S.R. 247 & 242
 LAKE CITY - COLUMBIA COUNTY - FLORIDA

SCOPE OF WORK

- ① SCRAPE ALL LOOSE MATERIAL FROM EXISTING CEILING AND RETEXTURE CEILING.
- ② REMOVE EXISTING CEILING LIGHTS AND REPLACE WITH NEW SURFACE MOUNTED FIXTURES.
- ③ REMOVE EXISTING VINYL FLOORING AND INSTALL NEW CERAMIC TILE FLOOR.
- ④ REMOVE EXISTING FOOD COURT COUNTER AND INSTALL NEW COUNTERS AS SHOWN ON DRAWING.
- ⑤ INSTALL NEW BEER CAVE COOLER AS SHOWN ON DRAWINGS.
- ⑥ PAINT INTERIOR OF STORE AS NEEDED.
- ⑦ BOX-IN (6) EXISTING PIPE COLUMNS ON THE EXTERIOR COVERED ENTRANCE.

REVISION:

Copyright 2009
N.F. Geisler, Architect

DRAWN:

DJR

Building Renovation for:
S & S FOOD STORE # 11
 COLUMBIA COUNTY, FLORIDA
REVISED FLOOR PLAN

APP
 ARCHITECTURAL DRAFTING & DESIGN, INC.
 Lake City, FL 32055 - 386.752.4670

NG
 NICHOLAS GEISLER ARCHITECT
 1758 NW Brown Rd.
 Lake City, FL 32055
 386-752-5921

DATE:

11MAY2009

COMM:

SHEET:

A

1 OF 1

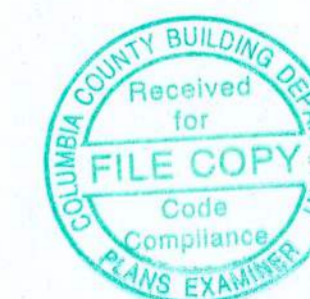

AR0007005